

PLATFORM TENNIS COURT CONSTRUCTION

IN THE BOROUGH OF SEA GIRT MONMOUTH COUNTY, NEW JERSEY

BOROUGH OF SEA GIRT	
MAYOR :	DONALD FETZER
COUNCIL PRESIDENT :	DIANE ANTHONY
COUNCIL MEMBERS :	MARK CLEMMENSEN BRYAN PERRY DR. MARIA RICHMAN ALAN ZAKIN
ADMINISTRATOR :	JAMES GANT

LIST OF DRAWINGS	
SHEET NUMBER	DESCRIPTION
1	COVER SHEET
2	CONSTRUCTION PLAN AND DETAILS
3	DETAILS

GENERAL NOTES

1. THE CONTRACTOR SHALL MEASURE AND VERIFY ALL DIMENSIONS AND CONDITIONS AT THE SITE PRIOR TO SUBMISSION OF HIS BID. HE SHALL NOTIFY THE ENGINEER OF ANY CONDITION WHICH MAY ALTER THE INTENT OF THE PROJECT.
2. THE CONTRACT DRAWINGS INDICATE THE APPROXIMATE LOCATION OF EXISTING SUBSURFACE UTILITIES IN THE VICINITY OF THE PROJECT AND ARE NOT GUARANTEES FOR ACCURACY AND/OR COMPLETENESS. CONTRACTOR TO VERIFY BIRTH AND LOCATION OF ALL EXISTING UTILITIES PRIOR TO CONSTRUCTION (11-800-275-1001). ANY CONFLICTS WITH PROPOSED CONSTRUCTION ARE TO BE BROUGHT TO THE IMMEDIATE ATTENTION OF THE ENGINEER SO THAT CHANGES CAN BE MADE TO THE DESIGN TO CARRY OUT THE INTENT OF THE WORK. NO SEPARATE PAYMENT SHALL BE MADE FOR THE ABOVE WORK. CONTRACTOR'S COST SHALL BE INCLUDED IN OTHER VARIOUS RELATED WORK ITEMS.
3. ADDITIONAL WORK MAY BE MARKED BY THE ENGINEER FOR CONSTRUCTION THROUGHOUT THE PROJECT.
4. THE CONTRACTOR SHALL EXERCISE EXTREME CARE WHEN WORKING AROUND EXISTING TREES TO AVOID DAMAGE TO TREE LIMBS AND ROOT SYSTEMS. THE CONTRACTOR SHALL NOTIFY THE ENGINEER IF HE FEELS THAT TRIMMING OF LIMBS AND ROOTS ARE REQUIRED.

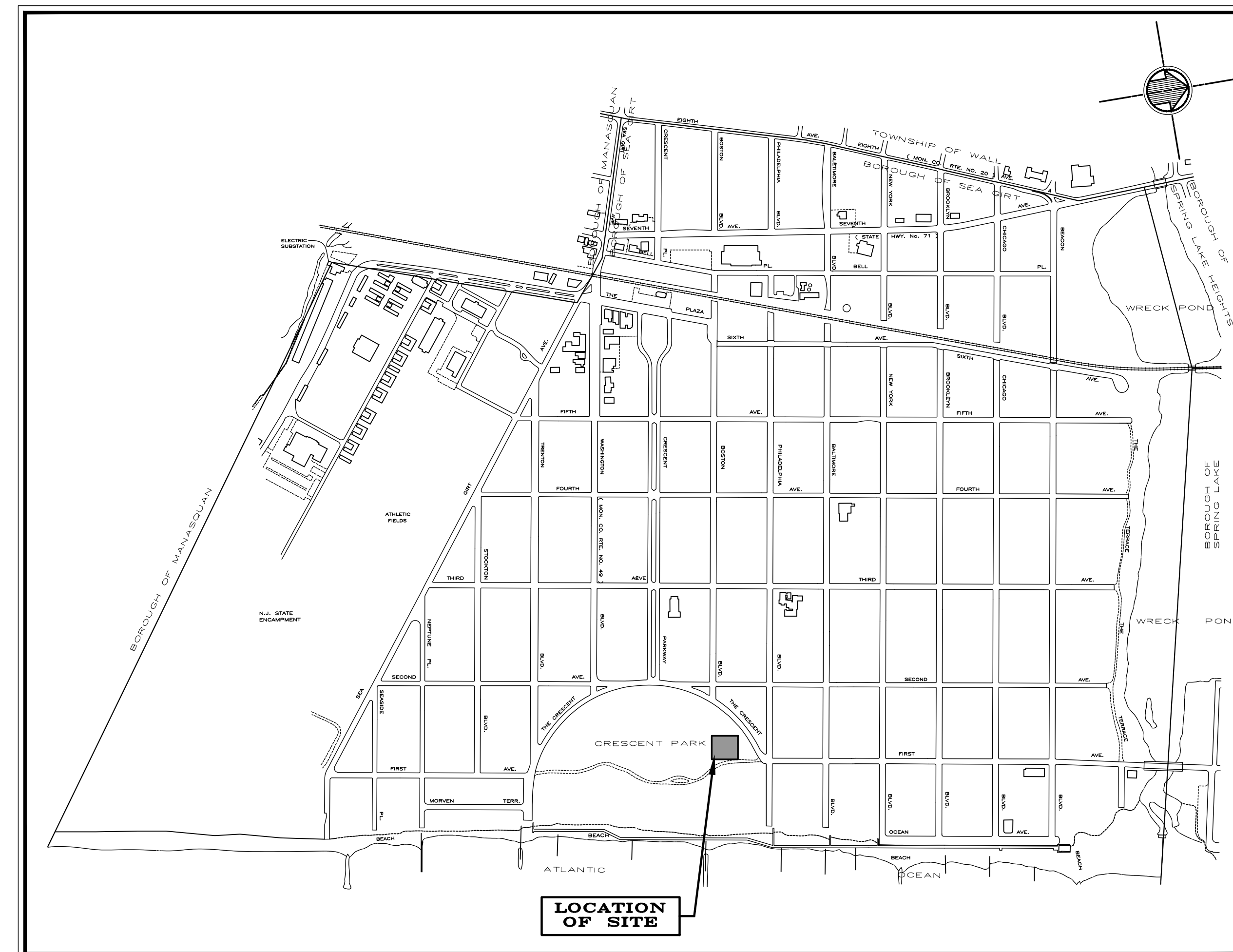

LOCATION PLAN
NOT TO SCALE

LEGEND

	AREA TO BE MILLED 0" - 3" DEPTH AS REQUIRED AND AS DIRECTED BY THE ENGINEER (TYPICAL)		EXISTING MANHOLE FRAME TO BE RESET TO PROPOSED GRADE
	AREA TO BE MILLED 3" - 6" DEPTH AS REQUIRED AND AS DIRECTED BY THE ENGINEER (TYPICAL)		EXISTING MANHOLE TO REMAIN
	NEW CONCRETE SIDEWALK		PROPOSED DRAINAGE INLET
	NEW CONCRETE DRIVEWAY APRON		EXISTING DRAINAGE INLET TO RECEIVE HEAD AND GRATE
	H.M.A. DRIVEWAY REPAIR		EXISTING DRAINAGE INLET TO REMAIN
	NEW CONCRETE CURB	OW.V.	EXISTING WATER VALVE
	EXISTING CONCRETE CURB TO REMAIN	OW.M.	EXISTING WATER METER
	RIGHT OF WAY LINE	OG.V.	EXISTING GAS VALVE
			UTILITY POLE
			MAIL BOX
			SIGN
			HYDRANT
			EXISTING TREE TO REMAIN
			PROPOSED CURB RAMP

LEON S. AVAKIAN, INC.
Consulting Engineers
788 WAYSIDE ROAD
NEPTUNE, NEW JERSEY 07753
OFFICE: (732) 922-9229 FAX: (732) 922-0044

PETER R. AVAKIAN, P.E.
PROFESSIONAL ENGINEER N. J. LIC. NO. 28142

PRELIMINARY

DAETE

BOROUGH OF SEA GIRT

PLATFORM TENNIS COURT CONSTRUCTION

LOCATED AT
CRESCENT PARK
IN THE
BOROUGH OF SEA GIRT, MON. CO., N.J.

SCALE	DATE	DRAWN BY	CHECKED	JOB NO.	SHEET
As Shown	Jan. 4, 2022	L.P.C.	P.R.A.	SG 21-13	1 of 3